

# Miniature

→ 83 137 0



- Action with a wire
- Very low operating force
- Long mechanical life



## Main specifications

		With standard rotary action 83 137 0
<b>Function</b>	<b>Connections</b>	
I (changeover)	W3	
I (changeover)	W2	83 137 004
R (normally closed)	W2 - W3	●
C (normally open)	W2 - W3	●
		●
<b>Electrical characteristics</b>		
Rating nominal / 250 V AC (A)		5
Rating thermal / 250 V AC (A)		14
<b>Mechanical characteristics</b>		
maximum operating force N cm		0.12
Minimum release torque N cm		0.03
Overtravel torque N cm		0.5
Pre-travel- maximum (°)		26
Maximum differential travel (°)		14
Min. overtravel (°)		12
Ambient operating temperature (°C)		-20 → +125
Mechanical life (operations)		10 <sup>7</sup>
Contact gap (mm)		0.8
Weight (g)		7.2

## Additional specifications

### Components

#### Material

- Case : polyamide.
- Contacts : silver.

#### Lever

- Stainless steel wire.

## Product adaptations



- Special levers
- UL approval

## Principles

### Single break changeover switch

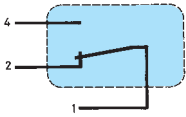

## Curves

### Operating curve for type 83 137 0

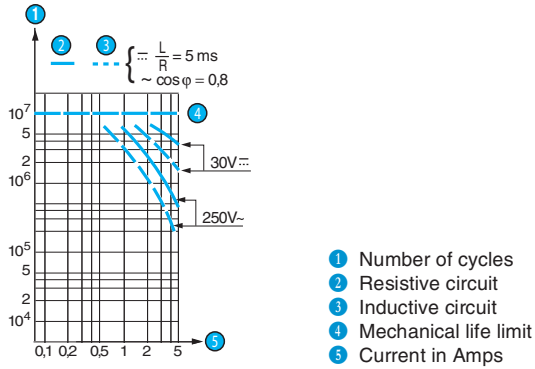

## Dimensions

### → Product

83 137 0

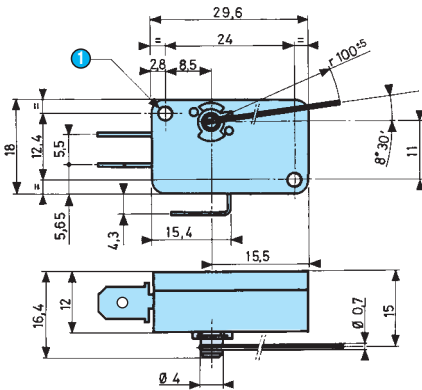

1 2 holes Ø 3.2

### → Connections

#### W2 solder

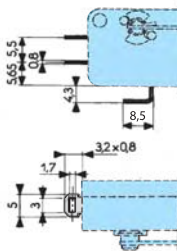

#### W3 for 6.35 mm clips

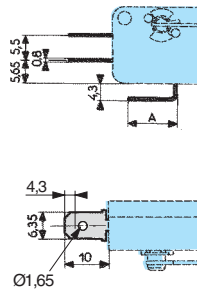

## Other information

### Mounting - Operation

See basic technical concepts