

**Standard sizes**

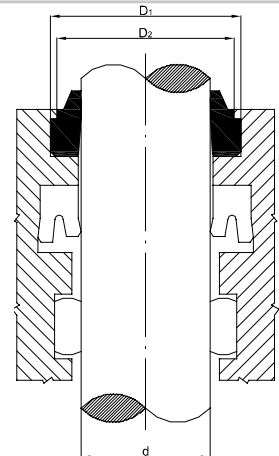
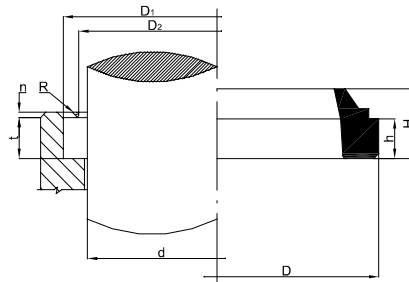

**Wiper seals DP8**

Reference	Road diameter mm	Wiper dimensions mm				Bore dimensions mm			
		d	D	h	H	D <sub>1</sub>	D <sub>2</sub>	t	R
DP8 8/16/4/7	8	8	16	4	7	16	14	4,15	1
DP8 10/18/4/7	10	10	18	4	7	18	16	4,15	1
DP8 12/20/4/7	12	12	20	4	7	20	18	4,15	1
DP8 14/22/4/7	14	14	22	4	7	22	20	4,15	1
DP8 16/24/4/7	16	16	24	4	7	24	22	4,15	1
DP8 18/26/4/7	18	18	26	4	7	26	24	4,15	1
DP8 20/28/4/7	20	20	28	4	7	28	26	4,15	1
DP8 22/30/4/7	22	22	30	4	7	30	28	4,15	1
DP8 25/33/4/7	25	25	33	4	7	33	31	4,15	1
DP8 28/36/4/7	28	28	36	4	7	36	34	4,15	1
DP8 30/38/4/7	30	30	38	4	7	38	36	4,15	1
DP8 32/40/4/7	32	32	40	4	7	40	38	4,15	1
DP8 35/43/4/7	35	35	43	4	7	43	41	4,15	1
DP8 36/44/4/7	36	36	44	4	7	44	42	4,15	1
DP8 40/48/4/7	40	40	48	4	7	48	46	4,15	1
DP8 42/50/4/7	42	42	50	4	7	50	48	4,15	1
DP8 45/53/4/7	45	45	53	4	7	53	51	4,15	1
DP8 48/56/4/7	48	48	56	4	7	56	54	4,15	1
DP8 50/58/4/7	50	50	58	4	7	58	56	4,15	1
DP8 55/63/4/7	55	55	63	4	7	63	61	4,15	1
DP8 56/64/4/7	56	56	64	4	7	64	62	4,15	1
DP8 60/68/4/7	60	60	68	4	7	68	66	4,15	1
DP8 63/71/4/7	63	63	71	4	7	71	69	4,15	1
DP8 65/73/4/7	65	65	73	4	7	73	71	4,15	1
DP8 70/78/4/7	70	70	78	4	7	78	76	4,15	1
DP8 80/88/4/7	80	80	88	4	7	88	86	4,15	1
DP8 85/93/4/7	85	85	93	4	7	93	91	4,15	1
DP8 90/98/4/7	90	90	98	4	7	98	96	4,15	1
DP8 100/108/4/7	100	100	108	4	7	108	106	4,15	1
DP8 110/122/5,5/10	110	110	122	5,5	10	122	119	5,65	1,5
DP8 120/132/5,5/10	120	120	132	5,5	10	132	129	5,65	1,5
DP8 125/137/5,5/10	125	125	137	5,5	10	137	134	5,65	1,5
DP8 140/152/5,5/10	140	140	152	5,5	10	152	149	5,65	1,5
DP8 160/172/5,5/10	160	160	172	5,5	10	172	169	5,65	1,5
DP8 180/192/5,5/10	180	180	192	5,5	10	192	189	5,65	1,5
DP8 200/212/5,5/10	200	200	212	5,5	10	212	209	5,65	1,5
DP8 220/235/6,5/13	220	220	235	6,5	13	235	231	6,65	2
DP8 250/265/6,5/13	250	250	265	6,5	13	265	261	6,65	2

DP8 wiper seals do not have any metal insert or case and are installed with slight interference in recessed grooves, so that the wiper can be locked into position in both axial and radial directions